

LAKE ERIE METROPARK SHORELINE RESTORATION - PHASE II AS-BUILTS

Project No. 51218.239
NOAA Grant No. NA16NMF4630341

HURON-CLINTON METROPARK AUTHORITY

SHEET INDEX

G1	COVER SHEET
C1	SLED HILL AND BEAN FIELD FINAL GRADING
C2-A	SLED HILL GRADING
C2-B	SHORELINE GRADING AND LWD AND SLABSTONE LOCATIONS
C3	SHORELINE SECTIONS
C4	SHORELINE SECTIONS
C5	CONSTRUCTED SITE DETAILS
C6	SHORELINE SEED AND TREES INSTALLED
C7	INSTALLED LEDGESTONE STEPS LANDING DETAILS

OWNER CONTACT:
TYLER MITCHELL, CHIEF OF NATURAL RESOURCES AND REGULATORY COMPLIANCE
HURON-CLINTON METROPARKS AUTHORITY, ADMINISTRATIVE OFFICE
13000 HIGH RIDGE DRIVE
BRIGHTON, MI 48114-9058 USA
(808) 321-2634

ENGINEER CONTACT:
SCOTT DIERKS, PE
SENIOR WATER RESOURCE ENGINEER
GEI CONSULTANTS
9282 GENERAL DRIVE, SUITE 180
PLYMOUTH, MI 48170

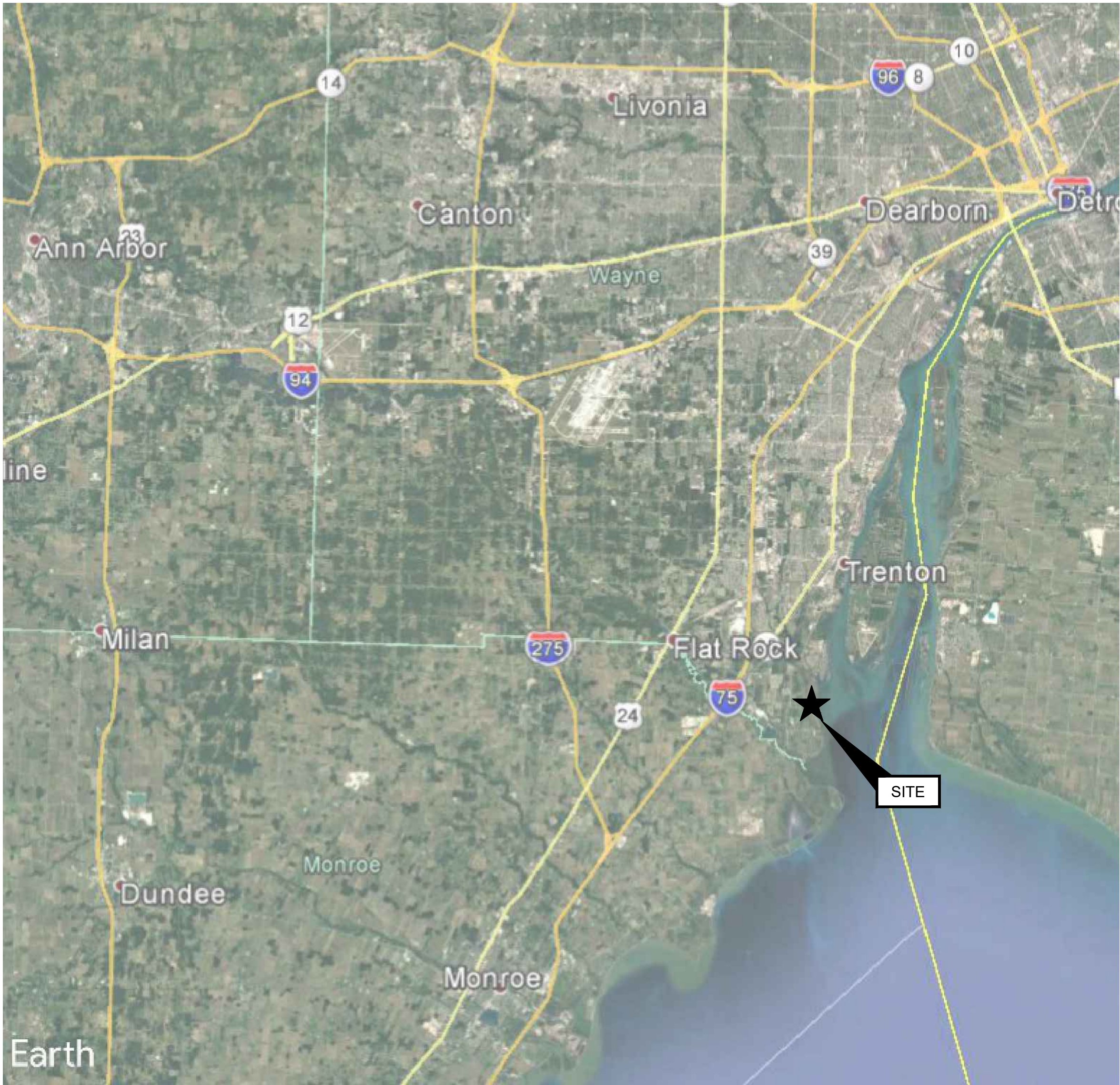

VICINITY MAP
SCALE: N.T.S.



LOCATION MAP
SCALE: N.T.S.



AS-BUILT



BEFORE YOU DIG
CALL MISS DIG
CALL 3 FULL WORKING DAYS
811 OR 1-800-480-7171

Warning:

It is a violation of Section 7209.2 of the New York State Education Law for any person, unless acting under the direction of a licensed professional engineer, to alter in any way plans, specifications, plats or reports to which the seal of a professional engineer has been applied. If an item bearing the seal of a professional engineer is altered, the altering engineer shall affix to the item his seal and the notation "Altered By" followed by his signature, the date, and a specific description of the alteration.

Attention:



If this scale bar does not measure 1" then drawing is not original scale.

1	6/2/2022	PERMIT SET	
2	7/1/2022	ISSUED FOR BIDDING	
3	10/10/2022	ISSUED FOR BIDDING	
4	12/6/2023	AS-BUILTS	
NO.	DATE	ISSUE/REVISION	APP

<i>Designed:</i>	MS
<i>Checked:</i>	SD
<i>Drawn:</i>	MS, HC
<i>Submitted By:</i>	SD
<i>P.E. Number:</i>	44371

GEI



HURON-CLINTON METROPARK
AUTHORITY

GEI Project 1903754

LAKE ERIE METROPARK SHORELINE
RESTORATION

COVER SHEET

DWG. NO.

G1

SHEET NO.

1 OF 9



LEGEND

WETLAND DELINEATION — WET —
OHWM - 573.67 — OHW —

Warning:

It is a violation of Section 7209.2 of the New York State Education Law for any person, unless acting under the direction of a licensed professional engineer, to alter in any way plans, specifications, plats or reports to which the seal of a professional engineer has been applied. If an item bearing the seal of a professional engineer is altered, the altering engineer shall affix to the item his seal and the notation "Altered By" followed by his signature, the date, and a specific description of the alteration.

Attention:



If this scale bar does not measure 1" then drawing is not original scale.

1	6/2/2022	PERMIT SET
2	7/1/2022	ISSUED FOR BIDDING
3	10/10/2022	ISSUED FOR BIDDING
4	12/6/2023	AS-BUILTS

NO.	DATE	ISSUE/REVISION
-----	------	----------------

APP

<i>Designed:</i>	MS
<i>Checked:</i>	SD
<i>Drawn:</i>	MS, HC
<i>Submitted By:</i>	SD
<i>P.E. Number:</i>	44371



HURON-CLINTON METROPARK
AUTHORITY

GEI Project 1903754

LAKE ERIE METROPARK SHORELINE
RESTORATION

SLED HILL AND BEAN
FIELD FINAL GRADING

DWG. NO.

C1

SHEET NO.

2 OF 9



BEFORE YOU DIG
CALL MISS DIG
CALL 3 FULL WORKING DAYS
811 OR 1-800-482-7171

AS-BUILT

TRUITT, ASHLEY, B|Working|HURON-CLINTON METROPOLITAN AUTHORITY\1903754 Lake Erie Metropark Coastal Restoration\CAD\08/01/2022 Shoreline Restoration Ph.2\As-Built\Sled Hill Design\As-Built.dwg - 12/15/2023

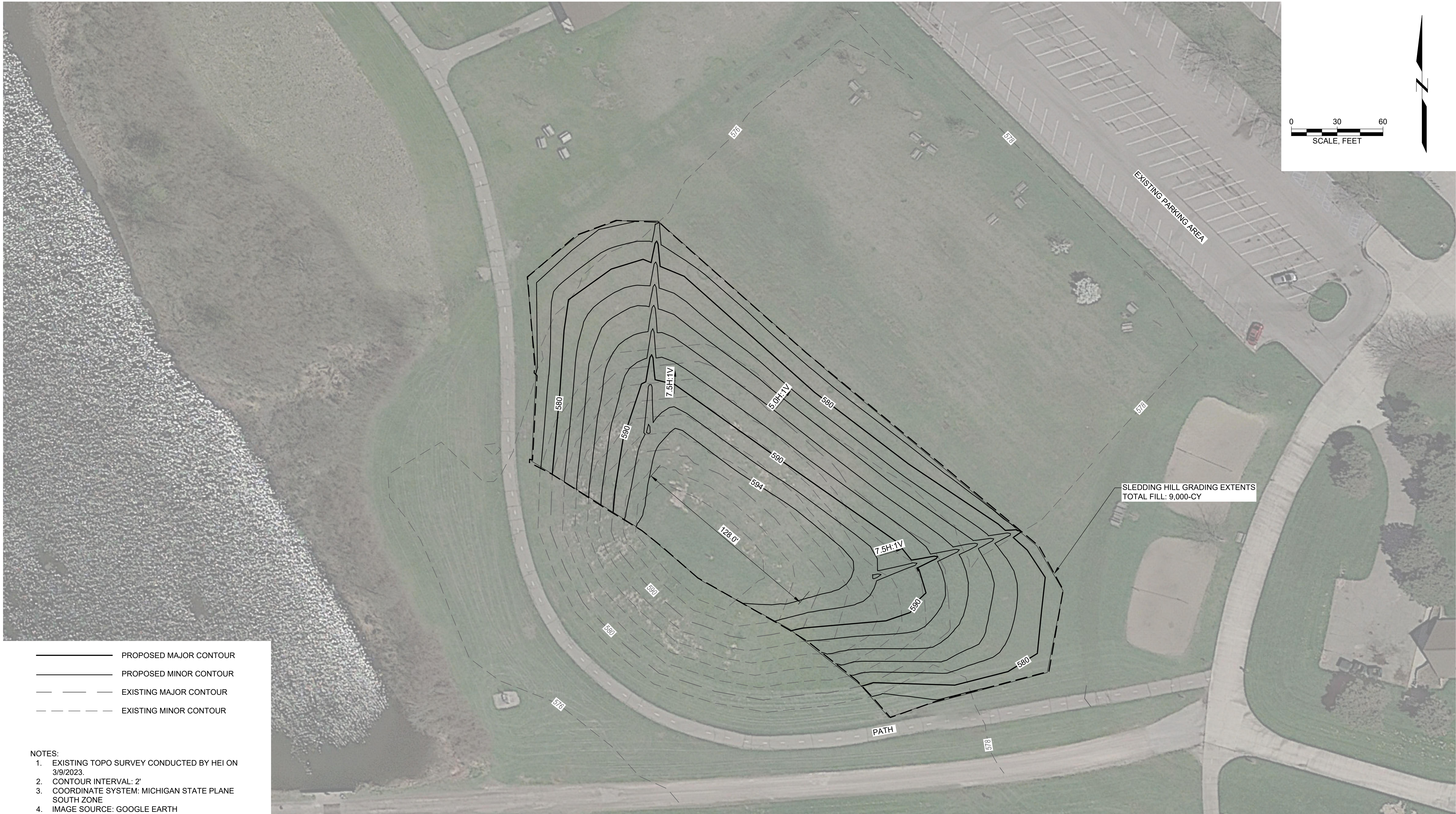

- PROPOSED MAJOR CONTOUR
- PROPOSED MINOR CONTOUR
- EXISTING MAJOR CONTOUR
- EXISTING MINOR CONTOUR

- NOTES:
- EXISTING TOPO SURVEY CONDUCTED BY HEI ON 3/9/2023.
 - CONTOUR INTERVAL: 2'
 - COORDINATE SYSTEM: MICHIGAN STATE PLANE SOUTH ZONE
 - IMAGE SOURCE: GOOGLE EARTH

AS-BUILT

<div>Warning:</div> <div>It is a violation of Section 7209.2 of the New York State Education Law for any person, unless acting under the direction of a licensed professional engineer, to alter in any way plans, specifications, plats or reports to which the seal of a professional engineer has been applied. If an item bearing the seal of a professional engineer is altered, the altering engineer shall affix to the item his seal and the notation "Altered By" followed by his signature, the date, and a specific description of the alteration.</div>	<div>Attention:</div> <div><div>01"</div><div>If this scale bar does not measure 1" then drawing is not original scale.</div></div>	1	6/2/2022	PERMIT SET		<div>Designed: MS</div> <div>Checked: SD</div> <div>Drawn: MS, HC</div> <div>Submitted By: SD</div> <div>P.E. Number: 44371</div>	<div>GEI Consultants</div> <div>HURON-CLINTON METROPARK AUTHORITY</div> <div>GEI Project 1903754</div>	LAKE ERIE METROPARK SHORELINE RESTORATION	DWG. NO.
		2	7/1/2022	ISSUED FOR BIDDING					C2-A
		3	10/10/2022	ISSUED FOR BIDDING				SLED HILL GRADING	SHEET NO.
		4	12/6/2023	AS-BUILTS					3 OF 9
		NO.	DATE	ISSUE/REVISION	APP				

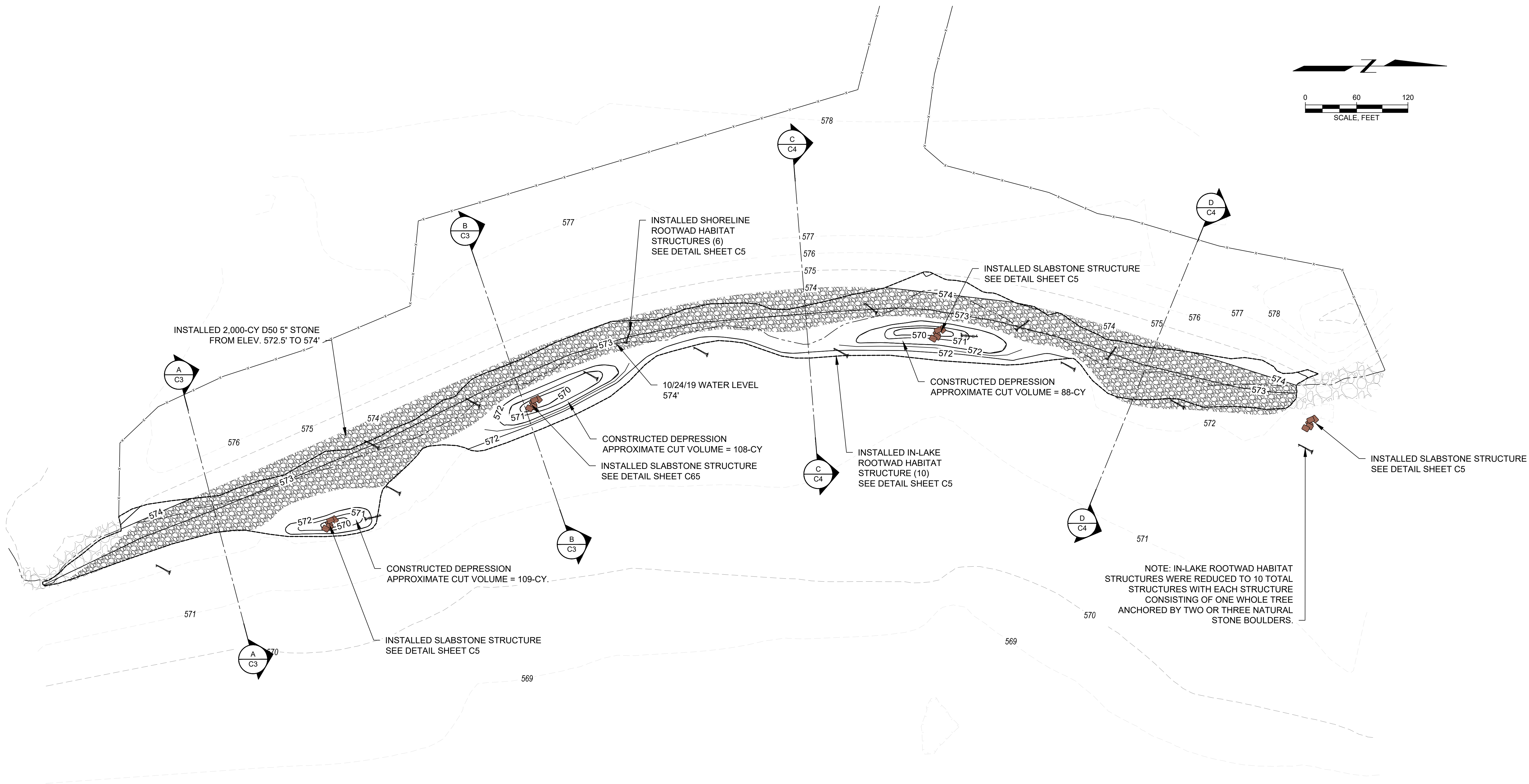
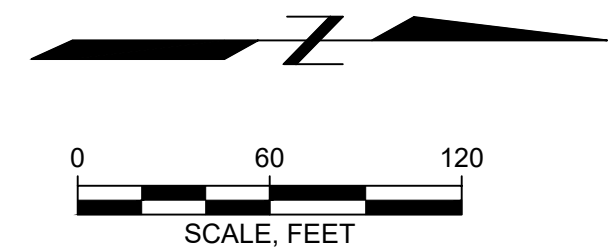

LEGEND

EX. MAJ. CONTOUR	---	PR. MAJ. CONTOUR	---
EX. MIN. CONTOUR	---	PR. MIN. CONTOUR	---
		GRADING LIMITS	---

EARTHWORK
CUT - 3,480 CY
FILL - 222 CY
NET - 3,258 CY CUT

AS-BUILT



<div>Warning:</div> <div>It is a violation of Section 7209.2 of the New York State Education Law for any person, unless acting under the direction of a licensed professional engineer, to alter in any way plans, specifications, plats or reports to which the seal of a professional engineer has been applied. If an item bearing the seal of a professional engineer is altered, the altering engineer shall affix to the item his seal and the notation "Altered By" followed by his signature, the date, and a specific description of the alteration.</div>	<div>Attention:</div> <div><div><div>0</div><div>1"</div></div><div>If this scale bar does not measure 1" then drawing is not original scale.</div></div>	1	6/2/2022	PERMIT SET		<div>Designed:</div> <div>MS</div>	<div>Checked:</div> <div>SD</div>	<div>Drawn:</div> <div>MS, HC</div>	<div>Submitted By:</div> <div>SD</div>	<div>P.E. Number:</div> <div>44371</div>	<div>GEI Consultants</div>	<div>HURON-CLINTON METROPARK AUTHORITY</div>	<div>GEI Project 1903754</div>	LAKE ERIE METROPARK SHORELINE RESTORATION	DWG. NO.			
			C2-B															
		SHORELINE GRADING AND LWD AND SLABSTONE LOCATIONS	SHEET NO.															
			4 OF 9															
		NO.	DATE	ISSUE/REVISION	APP													

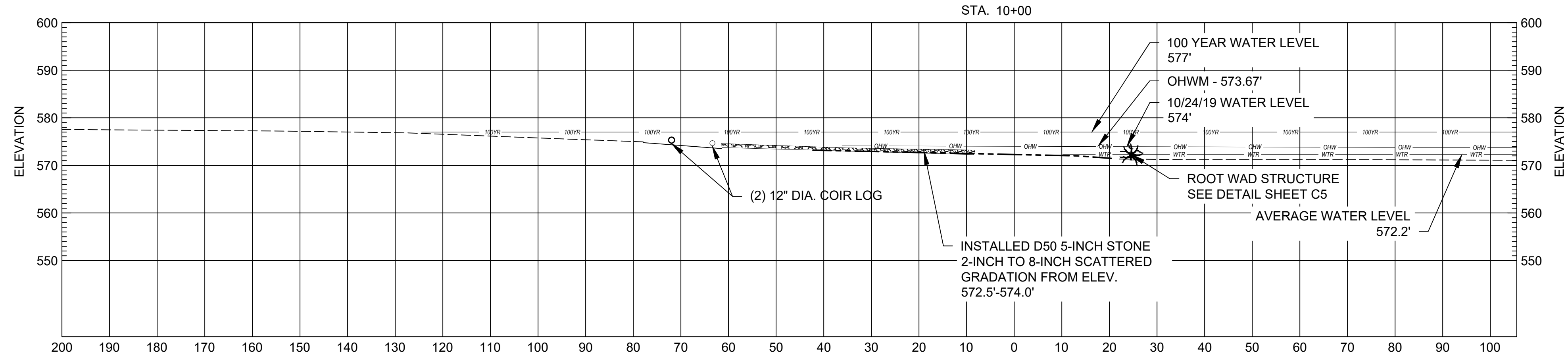

- LEGEND**
- EXISTING PRE-CONSTRUCTION GRADE
 - PROPOSED PHASE 2 GRADING
 - D50 5-INCH STONE
 - 100 YEAR FLOOD ELEVATION
 - OHWM
 - WTR SURVEYED WATER ELEVATION

C
C2B SECTION VIEW

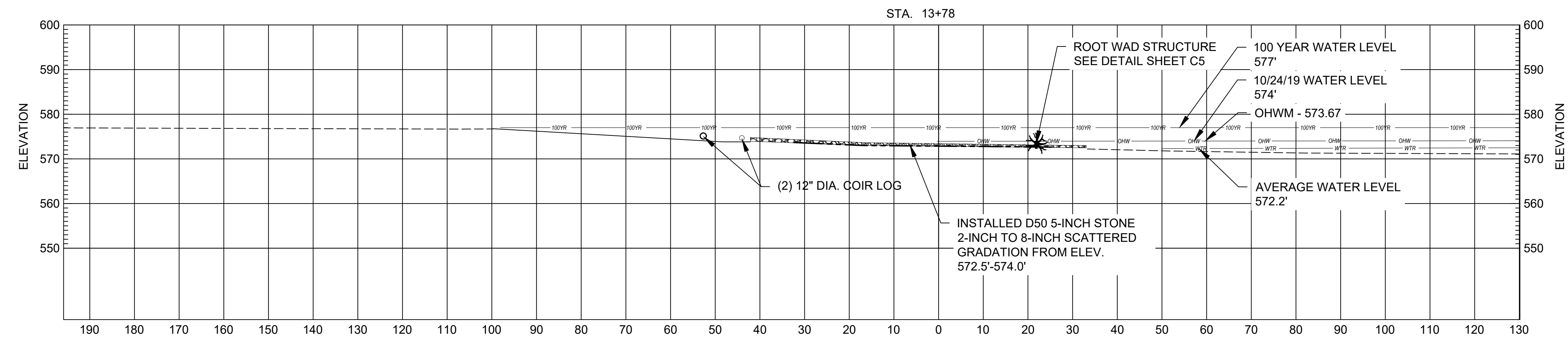

D
C2B SECTION VIEW

AS-BUILT



BEFORE YOU DIG
CALL MISS DIG
CALL 3 FULL WORKING DAYS
811 OR 1-800-480-7171

<div>Warning:</div> <div>It is a violation of Section 7209.2 of the New York State Education Law for any person, unless acting under the direction of a licensed professional engineer, to alter in any way plans, specifications, plats or reports to which the seal of a professional engineer has been applied. If an item bearing the seal of a professional engineer is altered, the altering engineer shall affix to the item his seal and the notation "Altered By" followed by his signature, the date, and a specific description of the alteration.</div>	<div>Attention:</div> <div><div><div>0</div><div>1"</div></div><div>If this scale bar does not measure 1" then drawing is not original scale.</div></div>	1	6/2/2022	PERMIT SET		<div>Designed:</div> <div>MS</div>	<div>Checked:</div> <div>SD</div>	<div>Drawn:</div> <div>MS, HC</div>	<div>Submitted By:</div> <div>SD</div>	<div>P.E. Number:</div> <div>44371</div>	<div><div>GEI</div><div>Consultants</div></div>	<div>HURON-CLINTON METROPARK AUTHORITY</div>	<div>LAKE ERIE METROPARK SHORELINE RESTORATION</div>	DWG. NO.
		2	7/1/2022	ISSUED FOR BIDDING										C4
		3	10/10/2022	ISSUED FOR BIDDING										SHORELINE SECTIONS
		4	12/6/2023	AS-BUILTS										
														6 OF 9
		NO.	DATE	ISSUE/REVISION	APP									

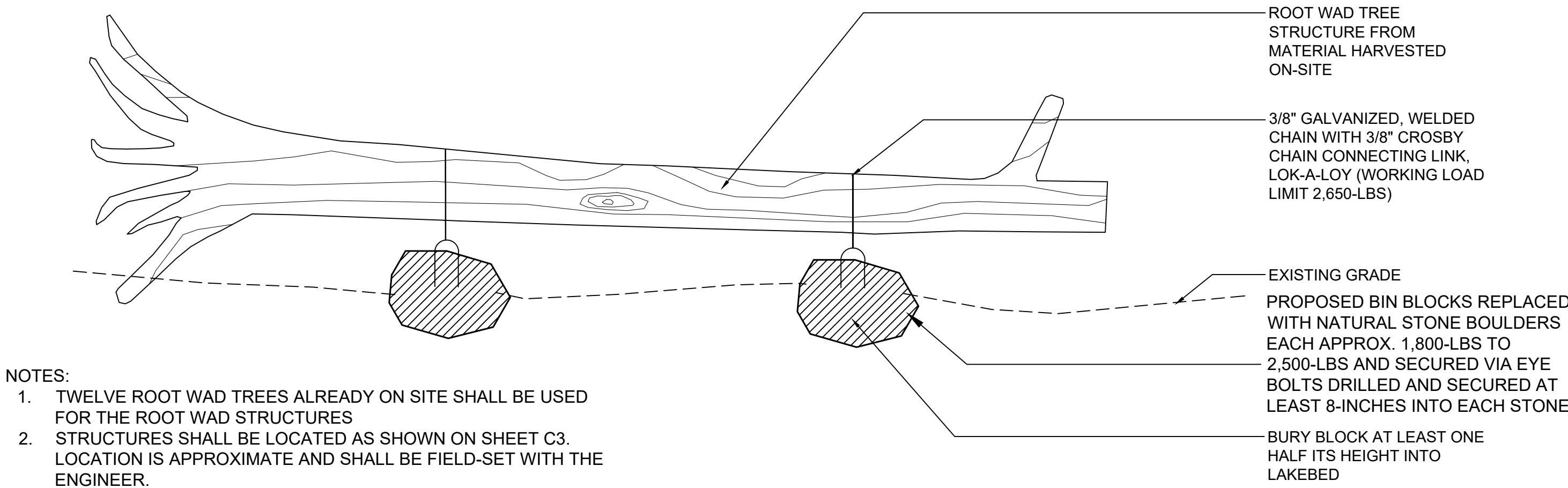

- NOTES:
1. TWELVE ROOT WAD TREES ALREADY ON SITE SHALL BE USED FOR THE ROOT WAD STRUCTURES
 2. STRUCTURES SHALL BE LOCATED AS SHOWN ON SHEET C3. LOCATION IS APPROXIMATE AND SHALL BE FIELD-SET WITH THE ENGINEER.

IN-LAKE ROOT WAD HABITAT STRUCTURE

NOT TO SCALE

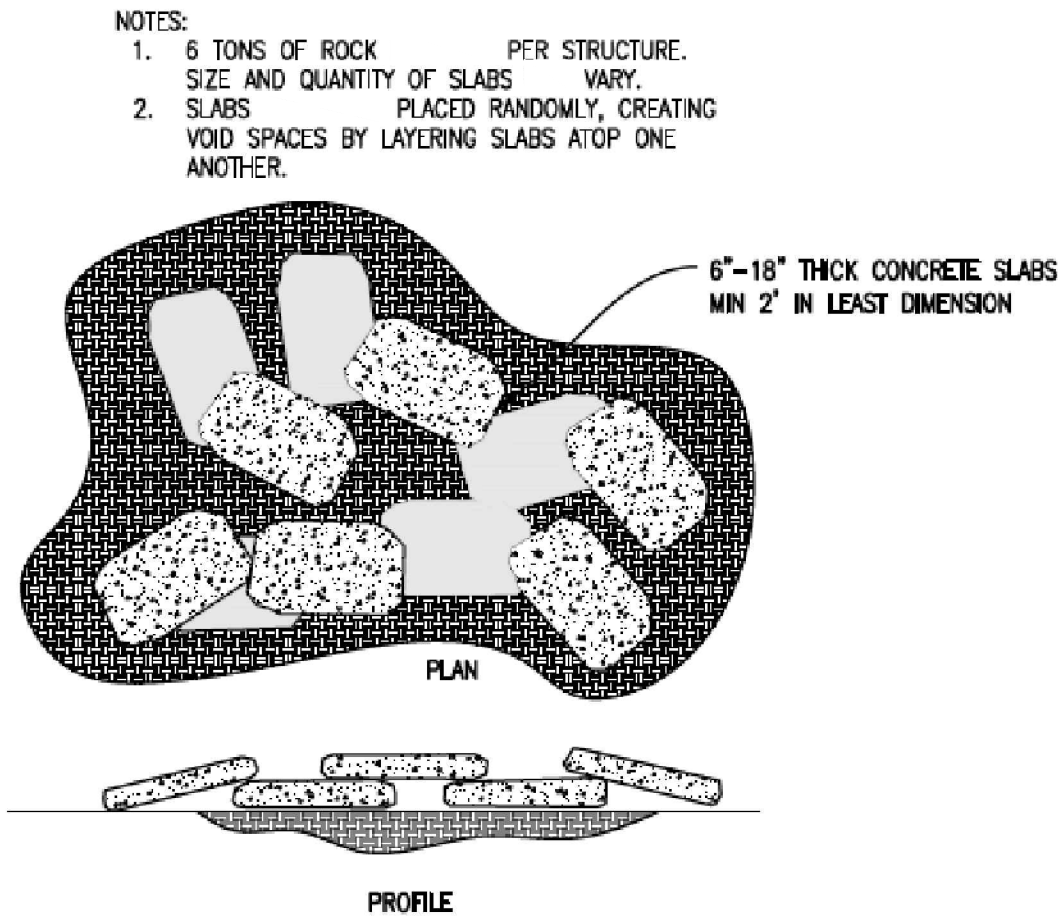

SLABSTONE STRUCTURE

NOT TO SCALE

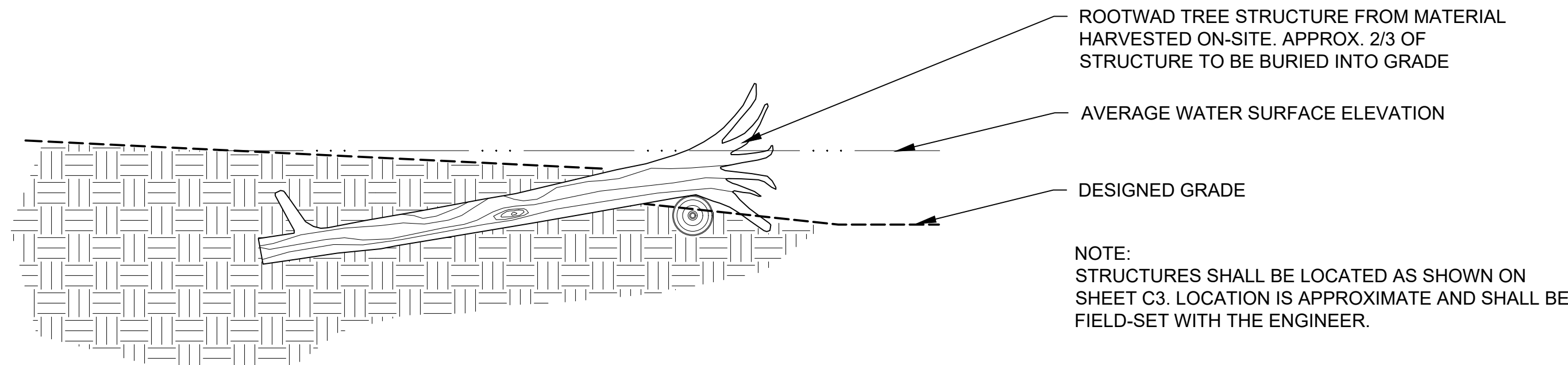

SHORELINE ROOT WAD HABITAT STRUCTURE

NOT TO SCALE

AS-BUILT



BEFORE YOU DIG
CALL MISS DIG
CALL 3 FULL WORKING DAYS
811 OR 1-800-482-7171

Warning:

It is a violation of Section 7209.2 of the New York State Education Law for any person, unless acting under the direction of a licensed professional engineer, to alter in any way plans, specifications, plats or reports to which the seal of a professional engineer has been applied. If an item bearing the seal of a professional engineer is altered, the altering engineer shall affix to the item his seal and the notation "Altered By" followed by his signature, the date, and a specific description of the alteration.

Attention:



If this scale bar does not measure 1" then drawing is not original scale.

1	6/2/2022	PERMIT SET	
2	7/1/2022	ISSUED FOR BIDDING	
3	10/10/2022	ISSUED FOR BIDDING	
4	12/6/2023	AS-BUILTS	
NO.	DATE	ISSUE/REVISION	APP

<i>Designed:</i>	MS
<i>Checked:</i>	SD
<i>Drawn:</i>	MS, HC
<i>Submitted By:</i>	SD
<i>P.E. Number:</i>	44371



HURON-CLINTON METROPARK
AUTHORITY

LAKE ERIE METROPARK SHORELINE
RESTORATION

CONSTRUCTED SITE DETAILS

GEI Project 1903754

DWG. NO.

C5

SHEET NO.

7 OF 9

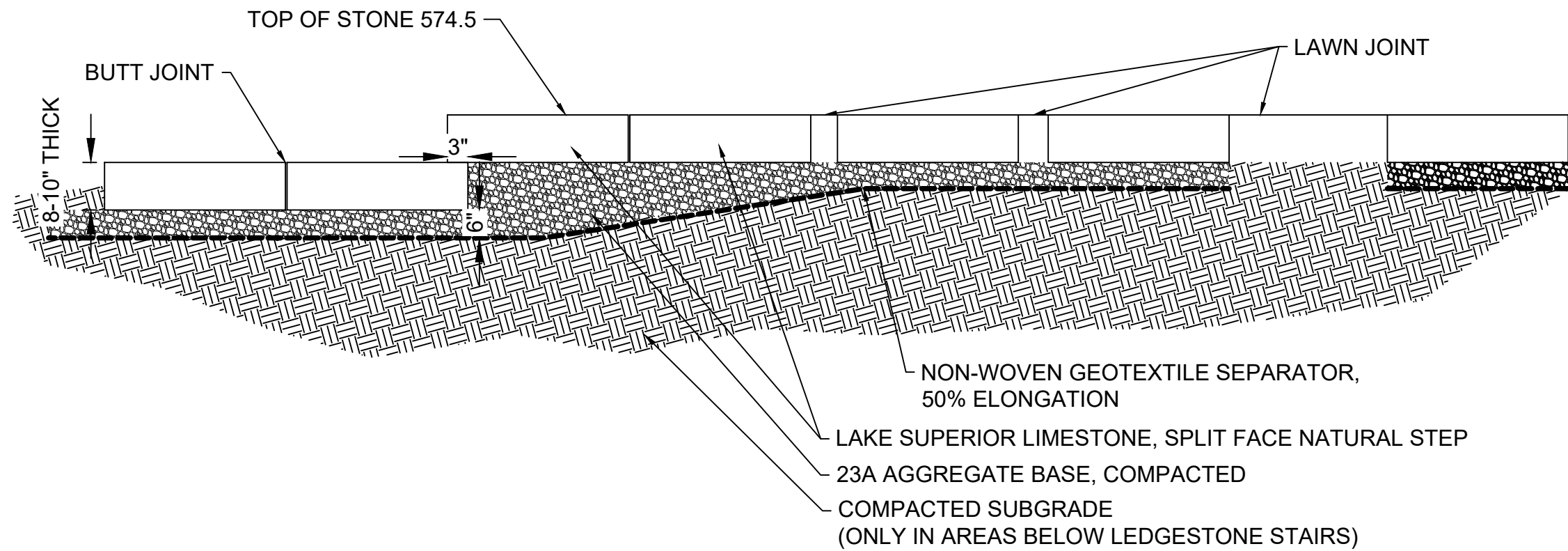

LEDGESTONE STEPS AND LANDING

NOT TO SCALE

AS-BUILT



BEFORE YOU DIG
CALL MISS DIG
CALL 3 FULL WORKING DAYS
811 OR 1-800-462-7171

Warning:
It is a violation of Section 7209.2 of the New York State Education Law for any person, unless acting under the direction of a licensed professional engineer, to alter in any way plans, specifications, plats or reports to which the seal of a professional engineer has been applied. If an item bearing the seal of a professional engineer is altered, the altering engineer shall affix to the item his seal and the notation "Altered By" followed by his signature, the date, and a specific description of the alteration.

Attention:
0 1"
If this scale bar does not measure 1" then drawing is not original scale.

1	6/2/2022	PERMIT SET	
2	7/1/2022	ISSUED FOR BIDDING	
3	10/10/2022	ISSUED FOR BIDDING	
4	12/6/2023	AS-BUILTS	
NO.	DATE	ISSUE/REVISION	APP

<i>Designed:</i>	MS
<i>Checked:</i>	SD
<i>Drawn:</i>	MS, HC
<i>Submitted By:</i>	SD
<i>P.E. Number:</i>	44371



HURON-CLINTON METROPARK AUTHORITY
GEI Project 1903754

LAKE ERIE METROPARK SHORELINE RESTORATION
INSTALLED LEDGESTONE STEPS AND LANDING DETAILS

DWG. NO. C7
SHEET NO. 9 OF 9